

READ THIS PAGE FIRST

CK-Mini

BLOWER HOSE & FLUID LINE GUIDE

1. Attach the blower hose to the CK-Mini machine by lining up hose and turning the hose collar clockwise to securely fasten the hose to the machine.
2. Connect clear fluid line from the end of the hose to the CK-Mini Machine. Insert until you hear a click or feel it sit on the bottom.

TO REMOVE FLUID LINE:

1. Remove the small blue retainer clip. (The one close to where you connected the fluid line.)
2. Push small inner lip down.
3. Remove clear fluid line.
4. Pull small inner lip up and re-insert small blue retainer clip. Make sure the tab on the small blue retainer clip is facing up, as shown in Figure 1.

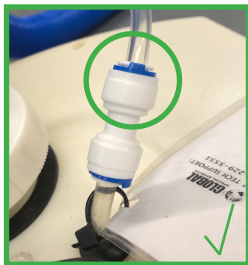
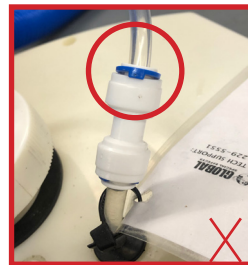

FIGURE 1



TO REMOVE BLOWER HOSE:

Turn the blower hose counter clockwise to remove.

READ THIS PAGE FIRST

CK-Mini

BLOWER HOSE & FLUID LINE GUIDE

1. Attach the blower hose to the CK-Mini machine by lining up hose and turning the hose collar clockwise to securely fasten the hose to the machine.
2. Connect clear fluid line from the end of the hose to the CK-Mini Machine. Insert until you hear a click or feel it sit on the bottom.

TO REMOVE FLUID LINE:

1. Remove the small blue retainer clip. (The one close to where you connected the fluid line.)
2. Push small inner lip down.
3. Remove clear fluid line.
4. Pull small inner lip up and re-insert small blue retainer clip. Make sure the tab on the small blue retainer clip is facing up, as shown in Figure 1.

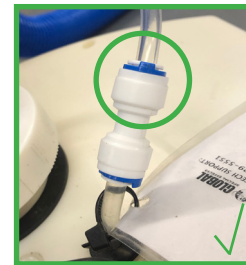
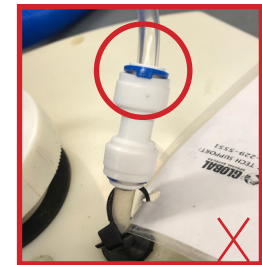

FIGURE 1



TO REMOVE BLOWER HOSE:

Turn the blower hose counter clockwise to remove.